



# CUBE HOMES

## The Curve

AT KINGSWAY



## LOOKING FOR A NEW HOME IN LEVENSHULME?

Four bedroom homes available to buy at £325,000; Help to Buy available.

For further details, please contact our marketing and sales agent.

**PLUMLIFE.**

Cube Homes, are delighted to present The Curve in sought after Levenshulme, offering modern four bedroom family homes for market sale.

These luxurious homes are beautifully finished to include an en-suite to the master bedroom and contemporary kitchen and bathroom suites.

Contact us: 0161 447 5050 | [sales@plumlife.co.uk](mailto:sales@plumlife.co.uk) | [www.plumlife.co.uk](http://www.plumlife.co.uk)



# LOCATION

Moseley Road  
Levenshulme  
M19 2BZ

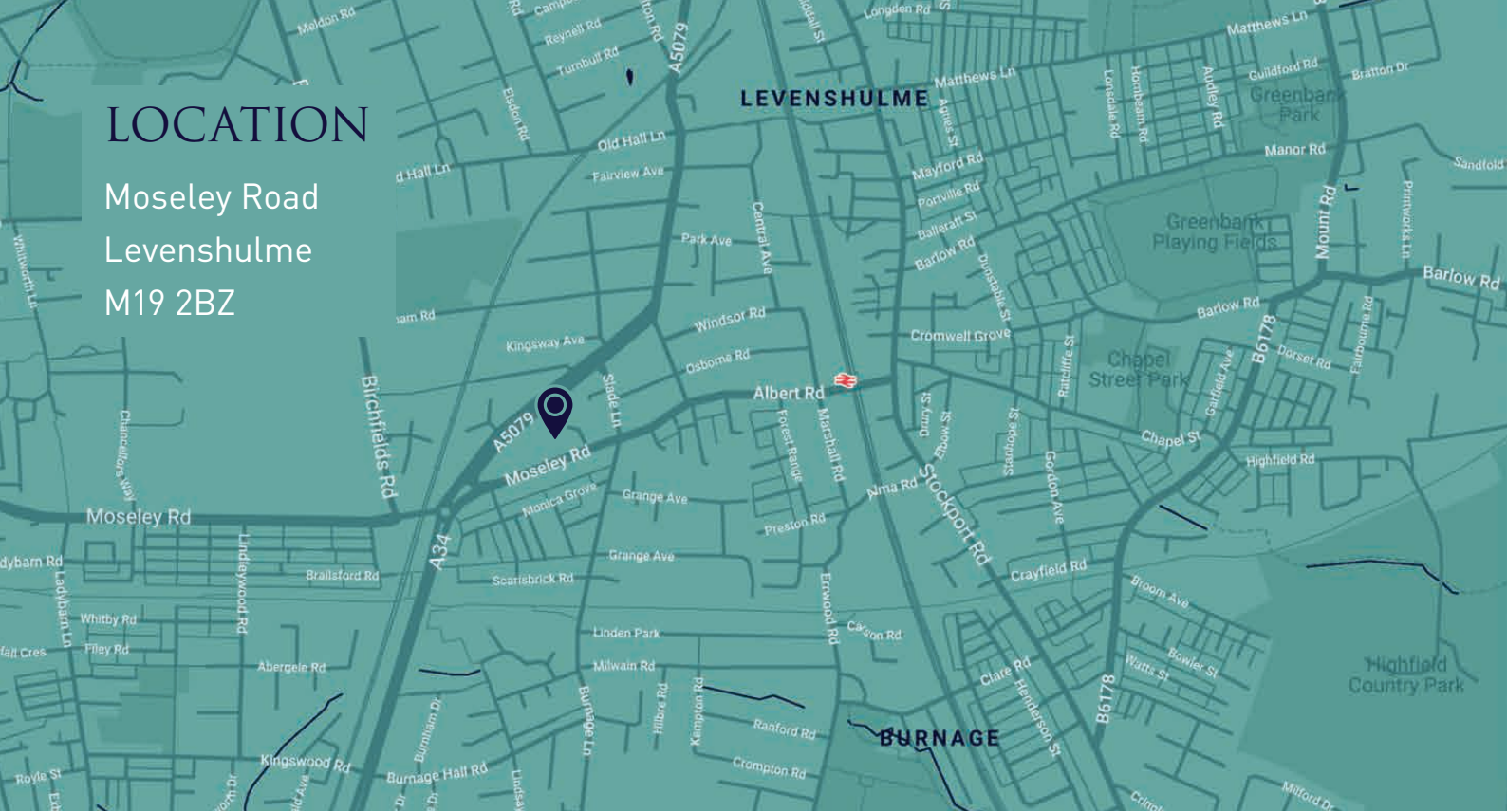

# FLOOR PLAN

Four-bedroom house 113.4 sq m

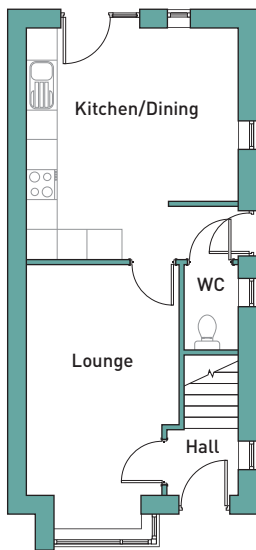

Ground floor

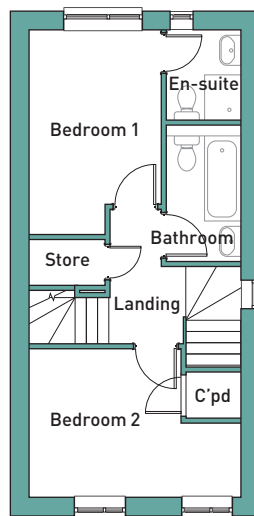

First floor

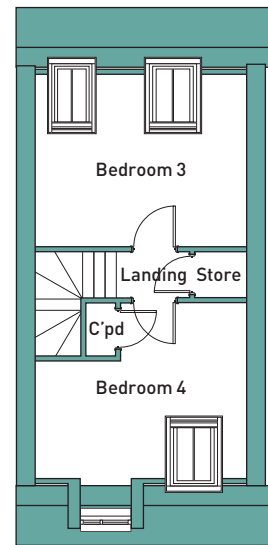

Second floor

## ALL HOMES INCLUDE:

- Contemporary Moores Definitives range kitchen suite
- Zanussi oven, five gas burner hob and extractor fan
- Allocated off-road parking
- Integrated Hotpoint fridge/freezer
- Vaillant ECOfit boiler
- Luxury Polyflor vinyl flooring to kitchens and bathrooms
- Melford Marble bathroom tiles
- Chrome heated towel rails
- 10-year LABC new homes warranty
- Turfed rear gardens

### Disclaimer

The details in this flyer are subject to change and do not constitute part of a contract. Prospective buyers must satisfy themselves by inspection or otherwise as to the accuracy of information given in the flyer.